

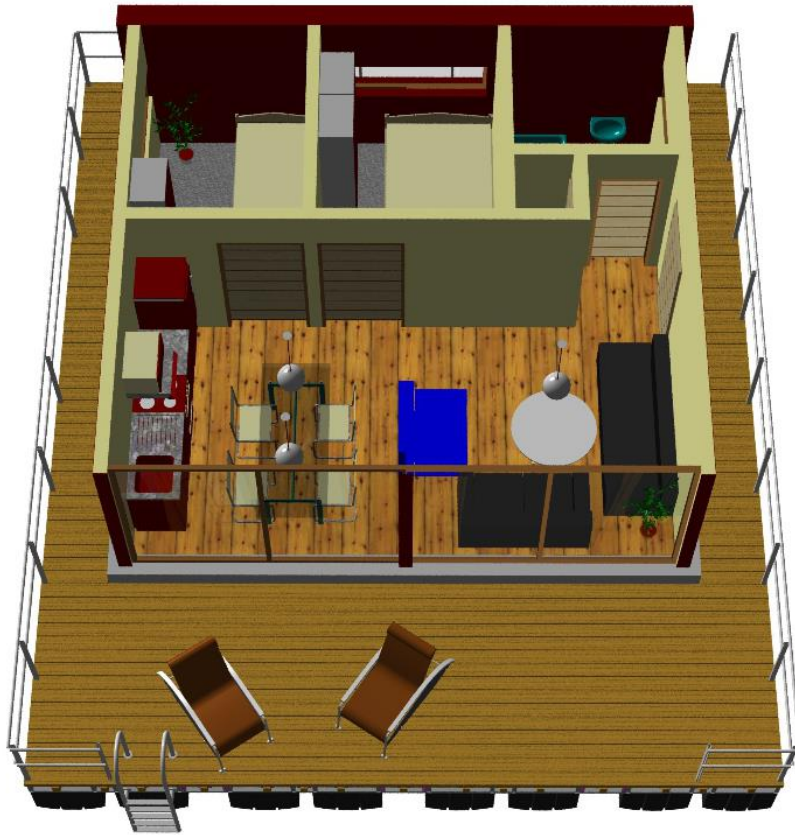

Perebo-house boats PH30 series





technical data/ description

total length:	9,65m (PH30-1), 12,05m (PH30-2)
total width:	8,45m
useable areas (lxb):	PH30-1 house area: 6,35m x 6,85m terrace area: 2,40m x 8,20m PH30-2 house area: 6,35m x 6,85m terrace area: 4,80m x 8,20m
room height:	2,20m
power supply:	with shore connection (on site)
water / wastewater:	with shore connection (on site)
bathroom:	PVC flooring, WC, washbasin, shower
sleeping and living area:	PVC flooring
furniture:	on request

advices:

- The anchorage and access to the house is dependent on the local conditions and the water situation.
- This floating house is designed for seasonal use from May to September + transitional period. (year-round use on request)



PEREBO GmbH & Co. KG
Hallenstraße 2
D-23966 Wismar
Fon: +49(0)3841-224049-0
Fax: +49(0)3841-224049-1
Mail: Info@perebo.de
Web: www.perebo.de